

SECTION A-A

- NOTES:
1. QUANTITY SUPPLIED:
  2. MATERIAL HANDLED:
  3. MATERIAL OF CONSTRUCTION:  
 FILLING NOZZLE:  
 SUPPORT FRAME:  
 PLUMBING FITTINGS:  
 HARDWARE:  
 GASKETS/SEALS:
  4. COMPRESSED AIR USAGE:  
 1-3 SCFM (SURGE), 80-100PSIG (PLANT AIR)
  5. WELDING, GRINDING AND CLEAN-UP PER Y.I. SPEC 185.200 AS FOLLOWS:  
 FILLING NOZZLE  
 WELDING - CLASS 2  
 GRINDING - CLASS 2  
 CLEAN-UP - CLASS 2  
  
 SUPPORT FRAME  
 WELDING - CLASS 1  
 GRINDING - CLASS 1  
 CLEAN-UP - CLASS 1
  6. PRIMER AND FINISH  
 ALL EXTERIOR CARBON STEEL TO BE PAINTED WITH ONE (1) COAT OF Y.I. GREY EPOXY PER Y.I. SPEC. 082.502  
 PURCHASED ITEMS FINISH PER MFG. STD
  7. GROUNDING & BONDING REQUIRED, SEE YOUNG INDUSTRIES DRAWING 1-1416-00 (REV .01 OR LATER)

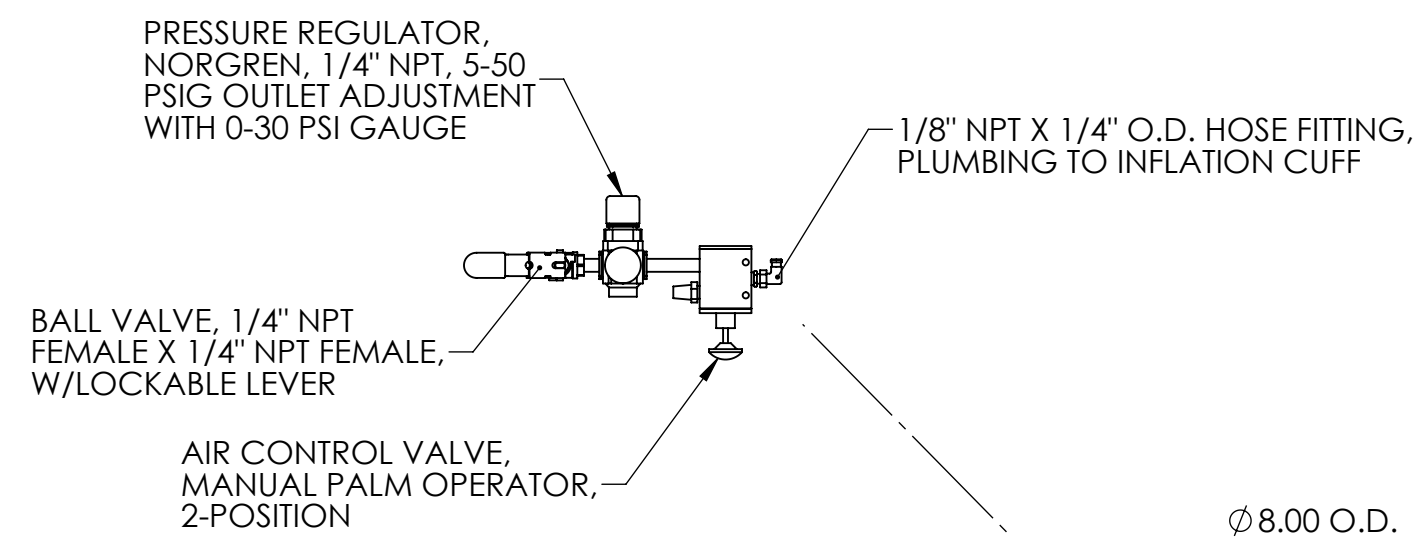
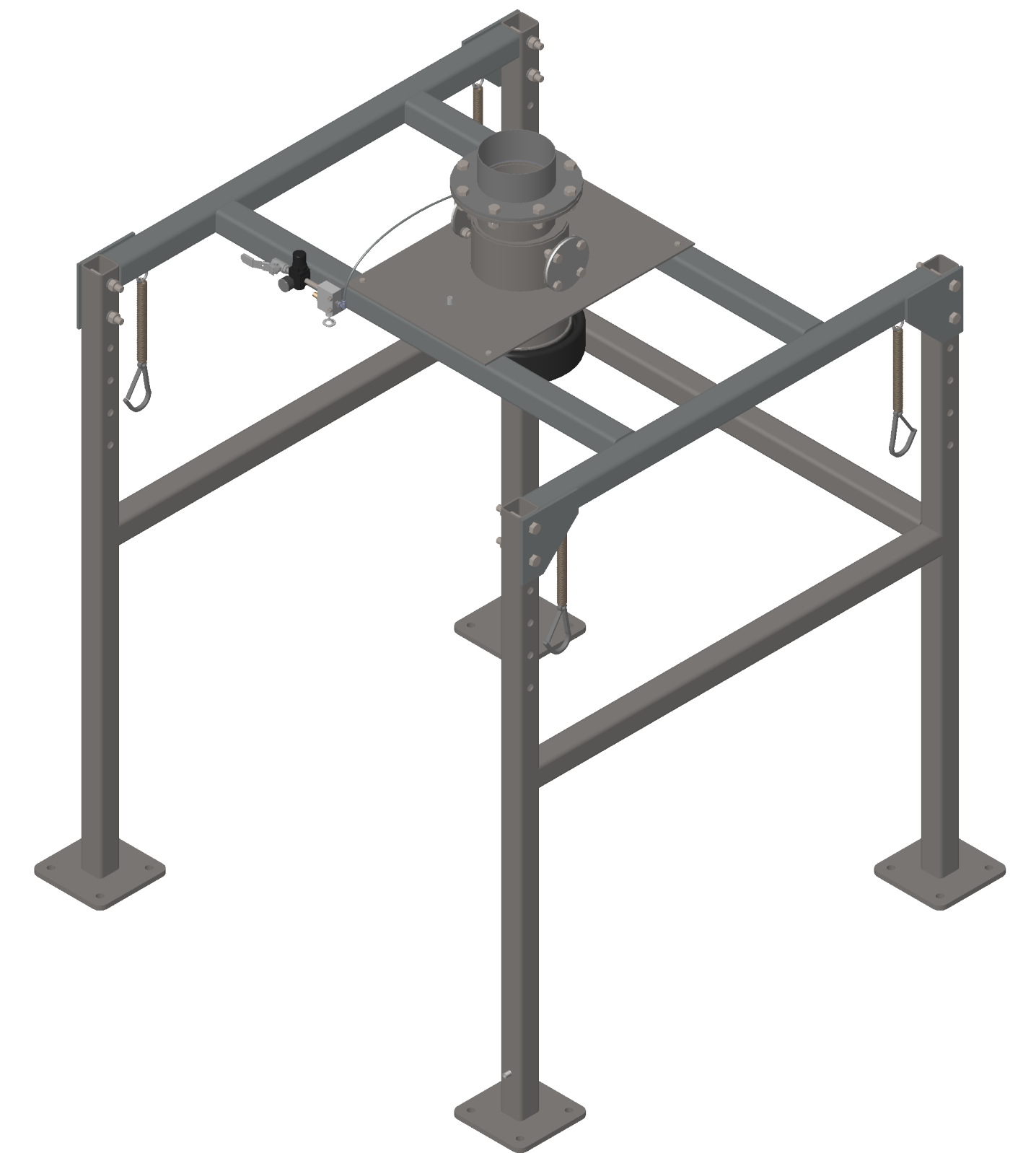

INFLATION CUFF AIR CONTROLS

(INFLATED DIMENSIONS ARE TO BE CONFIRMED BY CUSTOMER)

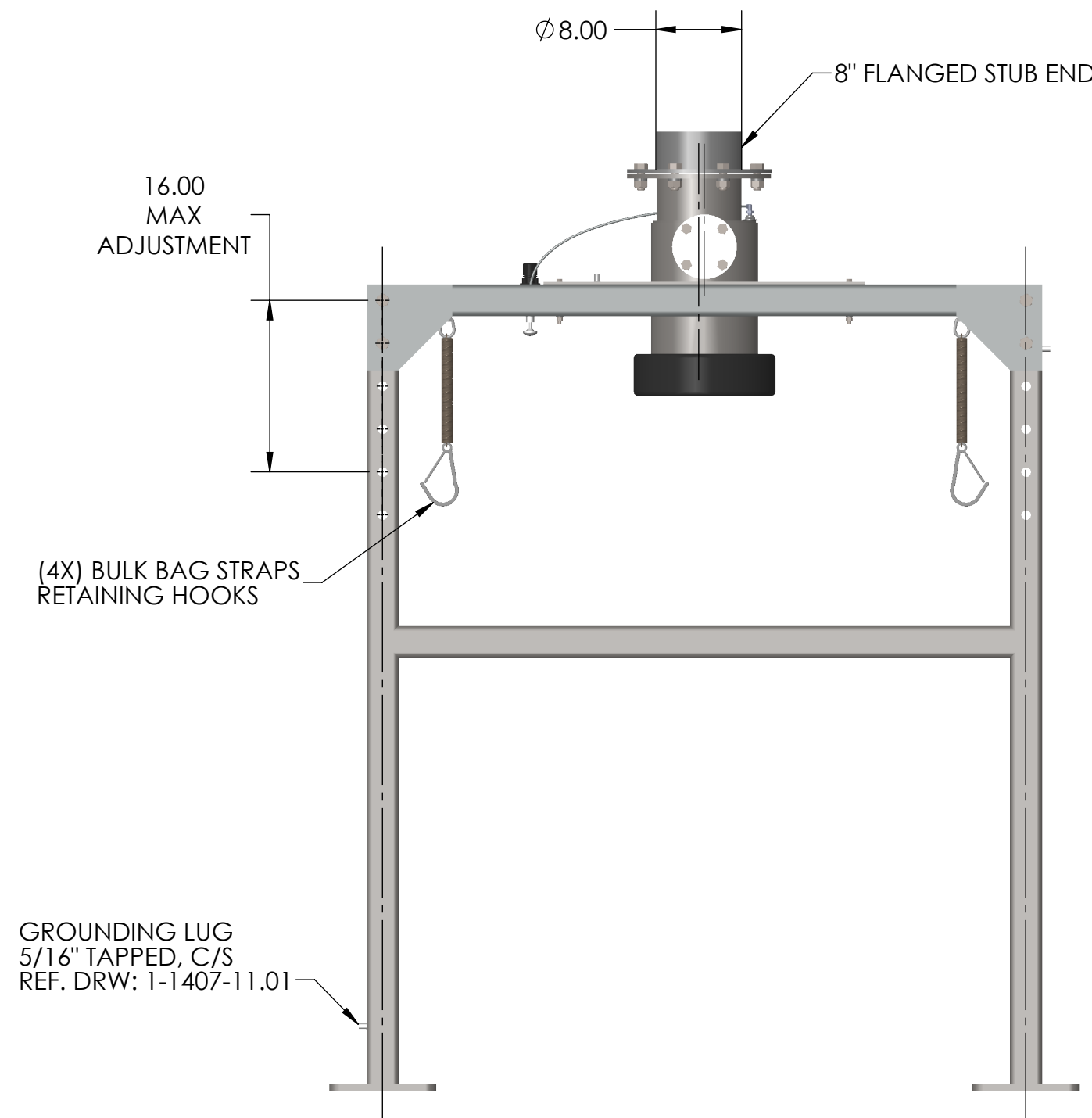
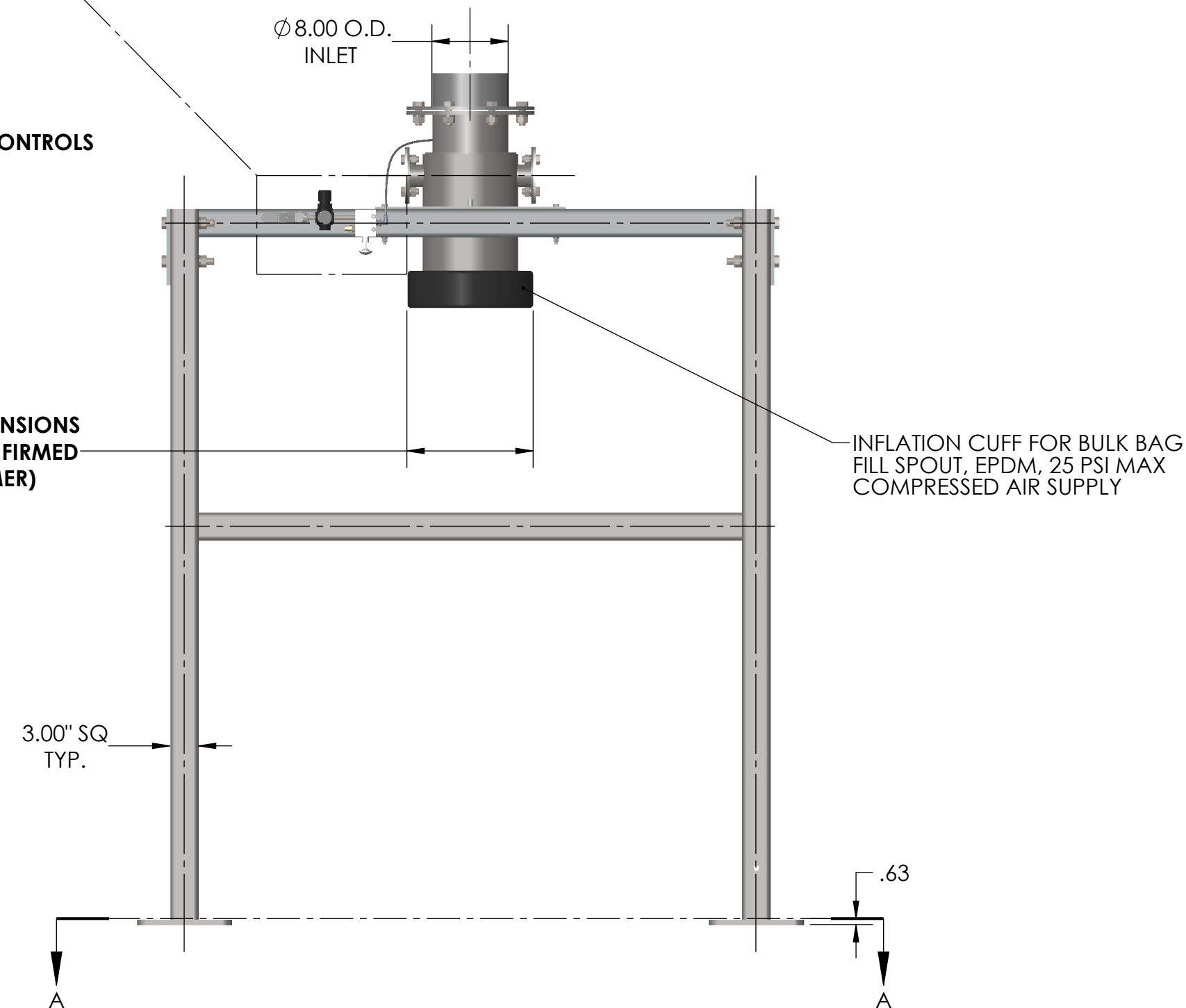

GROUNDING LUG  
 5/16\"/>

REV. NO.	DESCRIPTION	DATE	BY
REVISIONS			
CUSTOMER:			
CUSTOMER PO NUMBER:			
YOUNG JOB NUMBER:			
TITLE			
ASSEMBLY: BULK BAG FILLING FRAME, 5' SQ., ADJUSTABLE, 8" FILL NOZZLE,			
INDUSTRIES, INC. MUNCY, PENNSYLVANIA 17756 TELEPHONE: 570-546-3165			
DRAWN BY: JJD		DATE: 04/05/22	
CHECKED BY:		SCALE=1:14	
DRAWING NUMBER		SHEET	REV:
S-20009-20		1 OF 1	00

GENERAL TOLERANCES	
UNLESS OTHERWISE SPECIFIED THE FOLLOWING SHALL APPLY	
MACHINING - .XX= .02 .XXX= .005 ANGLE= 50°	
SURFACE ROUGHNESS HEIGHT 63 MICRONS OR LESS	
FABRICATION - UNDER 6 6 TO 24 24 TO 60 OVER 60	
± .06 ± .12 ± .19 ± .25	
UNLESS OTHERWISE SPECIFIED DIMENSIONS ARE IN INCHES	