

# VENTED BAG DUMP STATIONS

[WWW.YOUNGINDS.COM](http://WWW.YOUNGINDS.COM)

## SIZES

The Vented Bag Dump Stations are available in four standard sizes to cover most bag dumping applications. When the standard sizes do not fit the need of the application, we can provide custom units to meet the requirements. All stations provide a front shelf with tubular grating to support the bag while the operator cuts the bag open.



Tubular Bag Support Grating

**ADVANCED  
TECHNOLOGY  
PROVEN DESIGN**



Young Industries manufactures Bag Dump Stations with vent connections that are easily connected to users new or existing dust collection systems. The station design results in optimum inward air flow through the bag dump opening to provide efficient dust collection.

## CONFIGURATIONS

As with Young Industries Filter Bag Dump Stations, these Vented stations have many available configurations. Some of the standards are listed below

- ▶ **HOPPER TYPE** – With holding capacity and size as needed by the application
- ▶ **FLANGED TYPE** – Having a flange positioned directly under the grating these units can be mounted directly on top of bins or mixers
- ▶ **CONVEYOR ADAPTORS** – Transvair Aero-Mechanical Conveyors or Pneumatic convey systems can be used to convey powders from the station to process vessels



# VENTED BAG DUMP STATIONS

## OPTIONS

For stations that handle drums, Young Industries offers Portable Hydraulic Drum Dumpers to lift and tilt drums into the inlet opening of the station.

When disposal of empty bags is a concern, Young Industries offers two sizes of Empty Bag Compactors which are mounted to the side of the station. The empty bag is not removed from the dust-controlled area during the unloading and compaction cycle.

Young Industries can provide the Remote Dust Collector for the Bag Dump Station and design the complete dust collection system.

Young Industries Bag Dump Stations can be supplied with casters for portability. The stations are custom designed to meet the application requirements.



Vented Bag Dump Station



Portable Hydraulic Drum Dumper

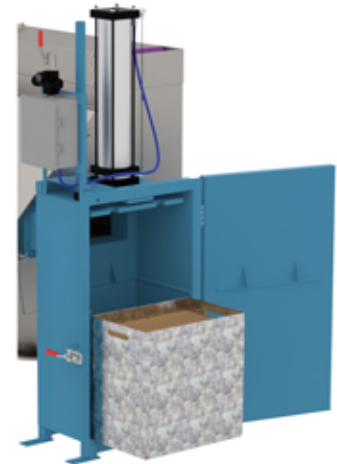

Empty Bag Compactor



Bag Dump With Transvair Aero-Mechanical Conveyor

SIZE	A	B	C	D	E	F	G	H	I	J
25"	25.0	12.5	21.5	29.0	30.0	21.5	7.0	6.0	17.0	68.5
32"	32.0	16.0	21.5	31.0	30.0	21.5	7.0	6.0	17.0	70.5
38"	38.0	19.0	24.0	42.0	38.0	24.0	8.0	7.0	24.0	78.0
45"	45.0	22.5	24.0	42.0	38.0	24.0	8.0	7.0	24.0	78.0

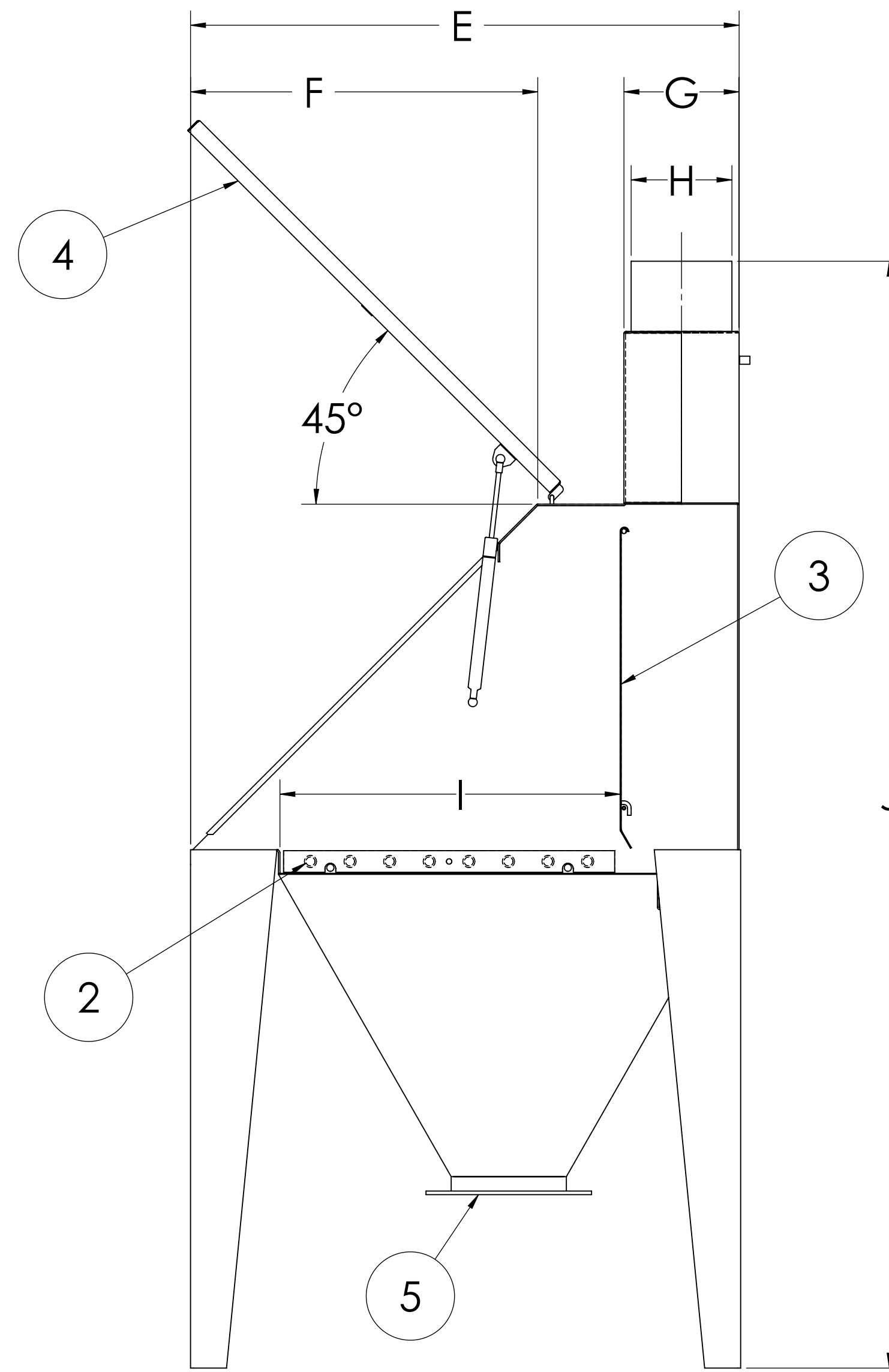
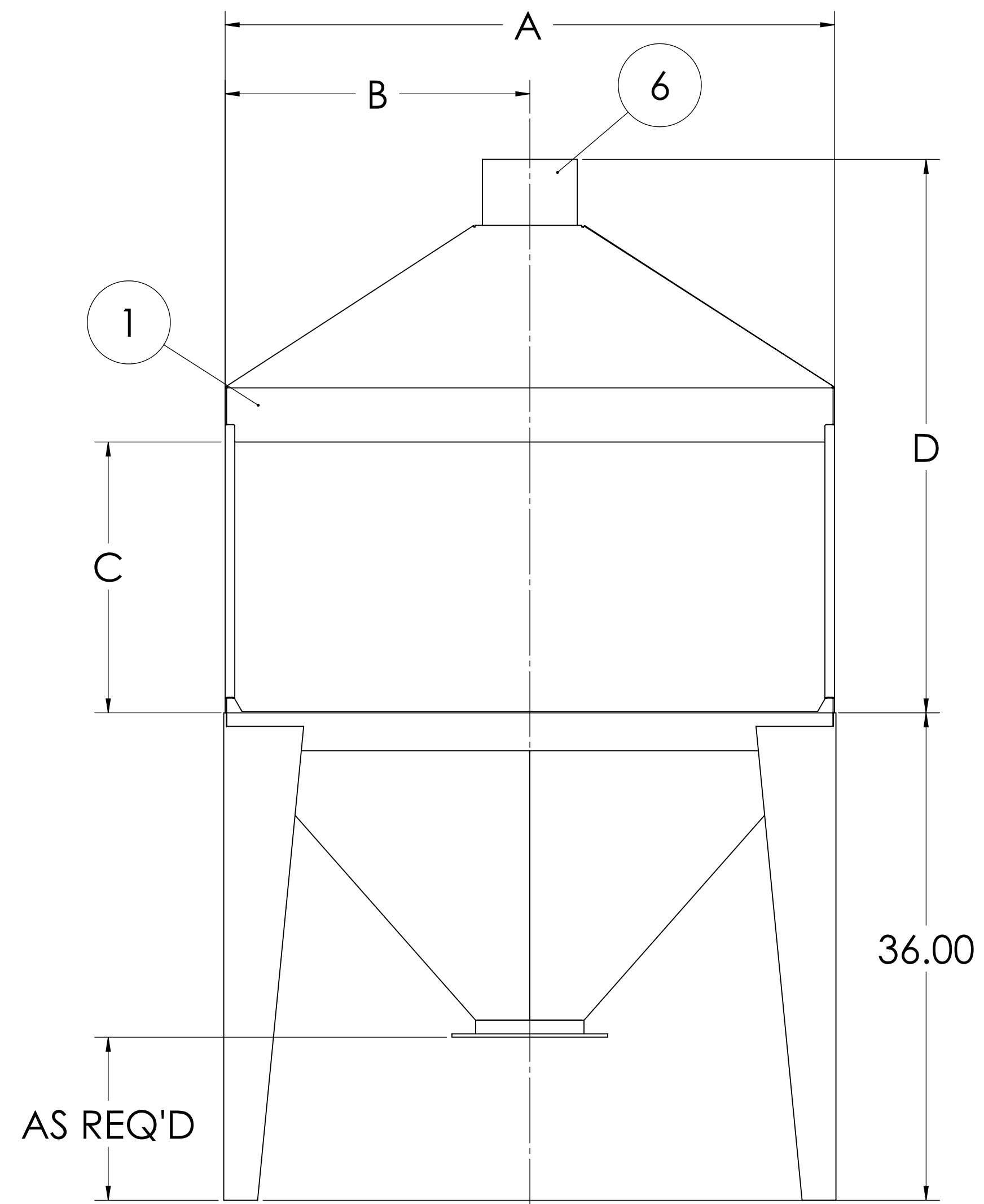

LEGEND:

- ① BAG DUMP STATION WITH DUST HOOD AND VENT CONNECTION
- ② SUPPORT GRATING, REMOVABLE
- ③ BAFFLE, REMOVABLE
- ④ HINGED CHARGE OPENING DOOR
- ⑤ DISCHARGE, FLANGED SIZE AS REQUIRED
- ⑥ VENT CONNECTION FOR ATTACHING TO DUST COLLECTION SYSTEM

REV. NO.	DESCRIPTION	DATE	BY
REVISIONS			
CUSTOMER:			
CUSTOMER PO NUMBER:			
YOUNG JOB NUMBER:			
TITLE			
BAG DUMP STATION WITH VENT CONNECTION			

**THE YOUNG INDUSTRIES, INC.**  
 MINICY, PENNSYLVANIA 17756  
 TELEPHONE: 570-546-3165

DRAWN BY: JAH      DATE: 01/21/21  
 CHECKED BY:      SCALE=1:8

DRAWING NUMBER: **S-4-6315**      SHEET 1 OF 1      REV: 00

GENERAL TOLERANCES	
UNLESS OTHERWISE SPECIFIED THE FOLLOWING SHALL APPLY	
MACHINING - .XX= .02 .XXX= .005 ANGLE= .50°	
SURFACE ROUGHNESS HEIGHT 63 MICRORINCHES OR LESS	
FABRICATION - UNDER 6 6 TO 24 24 TO 60 OVER 60	
± .06 ± .12 ± .19 ± .25	
UNLESS OTHERWISE SPECIFIED DIMENSIONS ARE IN INCHES	