

PELLET METERING MODEL SE ROTARY VALVE

WWW.YOUNGINDS.COM

STANDARD FEATURES:

- ▶ Heavy duty construction with 15 PSIG internal and differential pressure rating.
- ▶ Cast or fabricated construction of iron, carbon steel, or 300 series stainless steel.
- ▶ Standard design/operating temperature up to 250°F.
- ▶ Round or square inlet and discharge flanges.
- ▶ Outboard-mounted precision ball bearings.
- ▶ Packing gland provides a tight rotor shaft seal with four rings of PTFE impregnated Kevlar.
- ▶ Open or shrouded rotors.
- ▶ End plates are piloted to assure concentricity of the housing so that tight internal clearances between rotor and housing is provided.

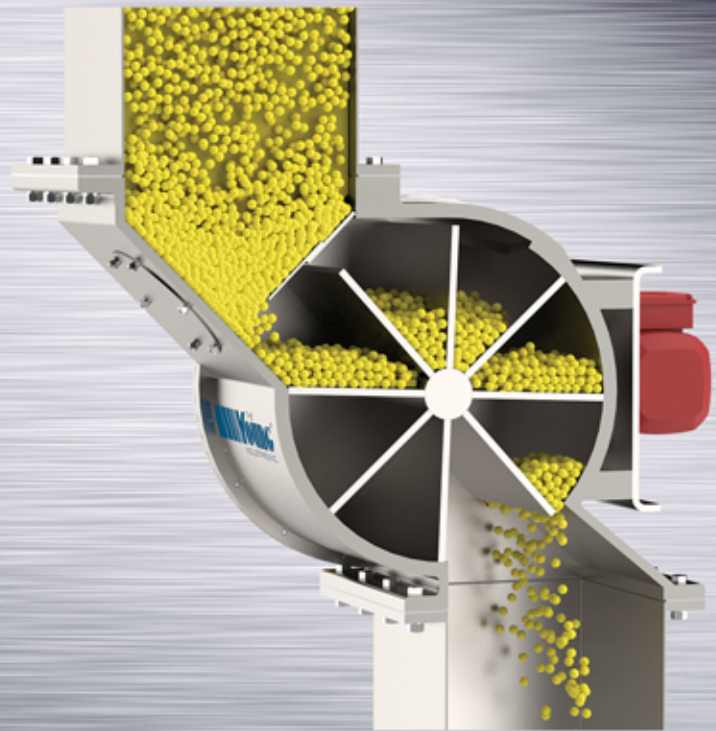

OFFSET INLET DESIGN. ELIMINATES SHEARING OF PELLETS.

The Young Industries, Inc. Model SE (Side Entry) Rotary Valve is specifically designed to meter pellets, chips, flakes, or prills larger than 1/16". These rotary valves have been proven to provide superior performance and reliability in a wide range of bulk materials handling applications. The over-all cost of ownership is very low while the service life of the valve is long.

The Model "SE" Rotary Valve features a large diameter rotor with the inlet of the valve off-set from the vertical centerline of the rotor. It operates at a fixed speed, and uses an adjustable inlet baffle to control product flow into the rotor pockets. The rotation of the rotor combined with the offset inlet throat eliminates the "pinch-point" that is present in conventional drop-thru rotary valves. This design is non-shearing and non-jamming, since the rotor is partially filled with product there is no pinching of material between the rotor tip and housing. Pinching of the granular products in conventional valves can create fines and put additional stress on the rotor.

The standard rotor has eight vanes to insure there is minimal gas leakage from the inlet to discharge. The precision machined housing and piloted end plates allows for very tight clearances.

**ADVANCED
TECHNOLOGY
PROVEN DESIGN**

Now Available

Rotary Valve Calculator App



MODEL SE ROTARY VALVE

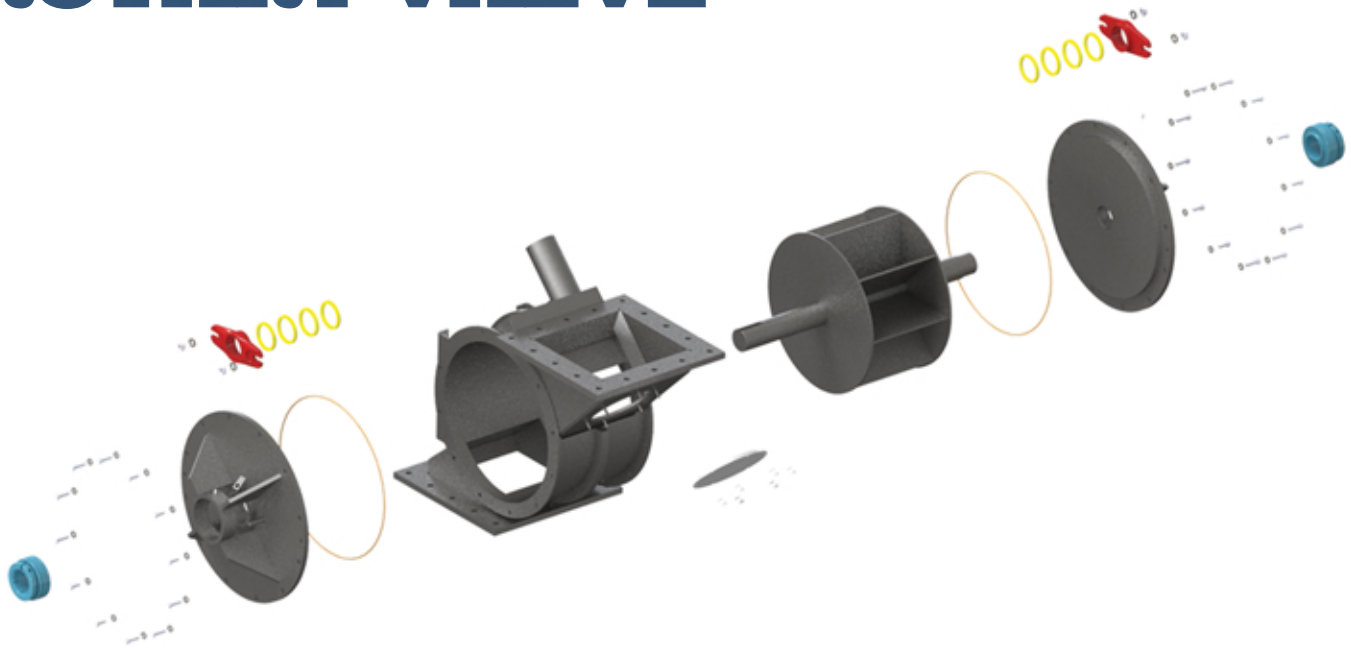

OPTIONAL FEATURES:

- ▶ High internal pressure designs available.
- ▶ High temperature designs up to 1500°F.
- ▶ Sizes from 4" up to 36" with double length styles available.
- ▶ Roller chain drive with parallel shaft TEFC driven gearmotor is standard with explosion proof motors of any specified manufacturer available.
- ▶ Shaft mounted drive is available.
- ▶ Special materials of construction including various grades of Stainless Steel, Hastelloy, Titanium, Inconel or Engineered Plastics.
- ▶ Interior polish or electro-polish per application requirement.
- ▶ Special packing materials of graphite, food grade PTFE or as needed by process.
- ▶ Interior coating for providing abrasion resistance or material release include hard chrome plating, nickel plating, tungsten carbide, Stellite, or Teflon
- ▶ Lantern ring with purge connection in the packing gland.
- ▶ Rotor shaft Mechanical Seals.
- ▶ Self-adjusting packing follower.
- ▶ Shaft seal coatings.
- ▶ Direct venting, with vent installed in the housing.
- ▶ End plate purges.
- ▶ Rotor tips and edges can be beveled.
- ▶ Replaceable rotor tips of flexible or abrasion resistant materials.
- ▶ Exterior painting and coatings to meet customer specifications.



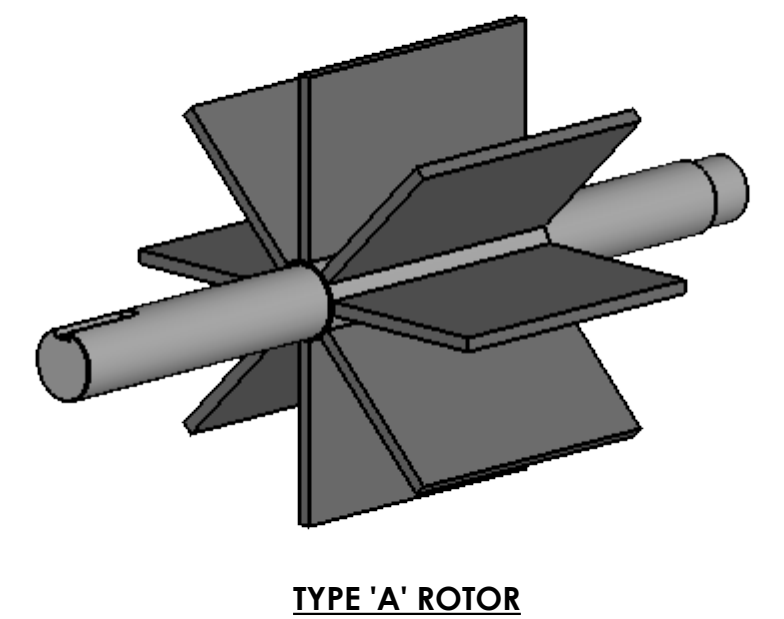
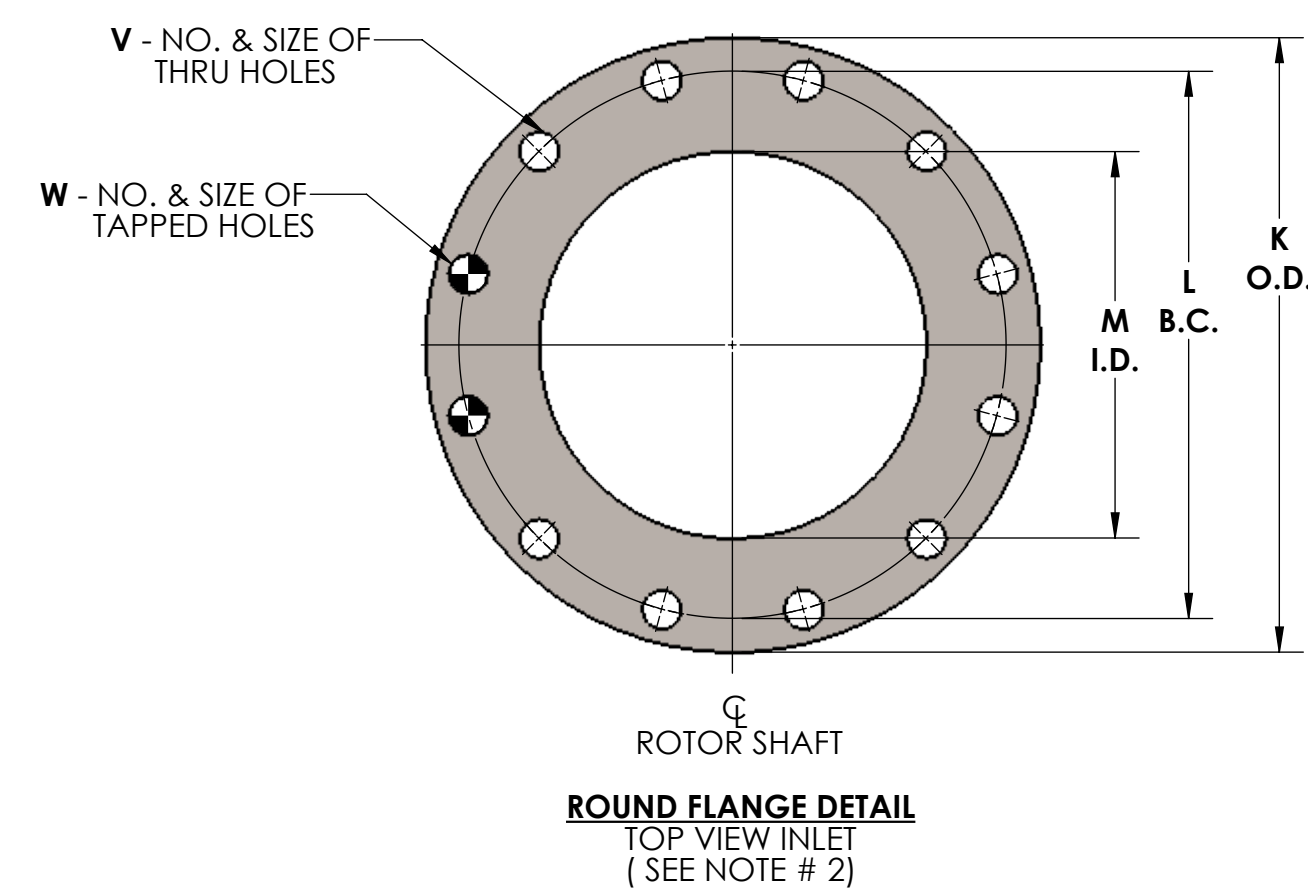
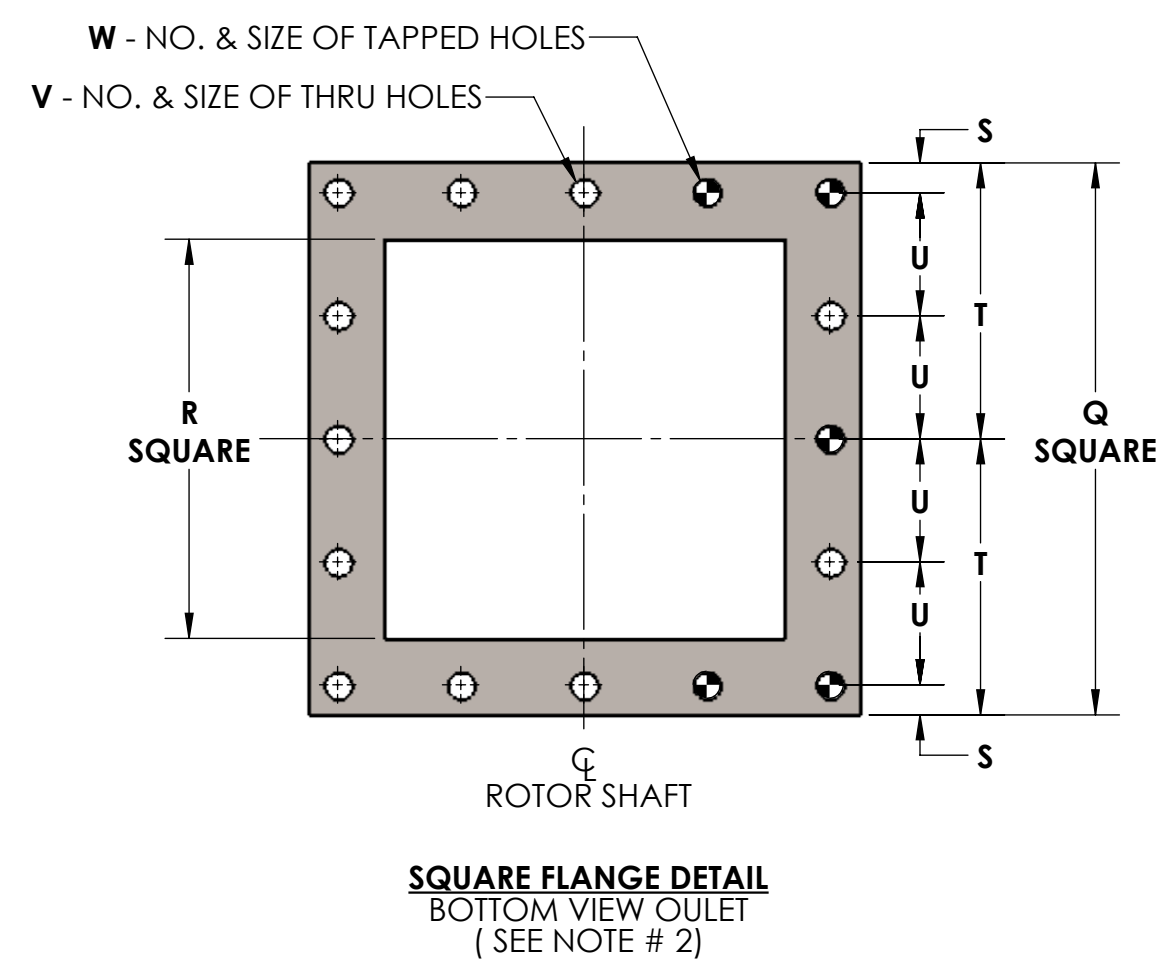
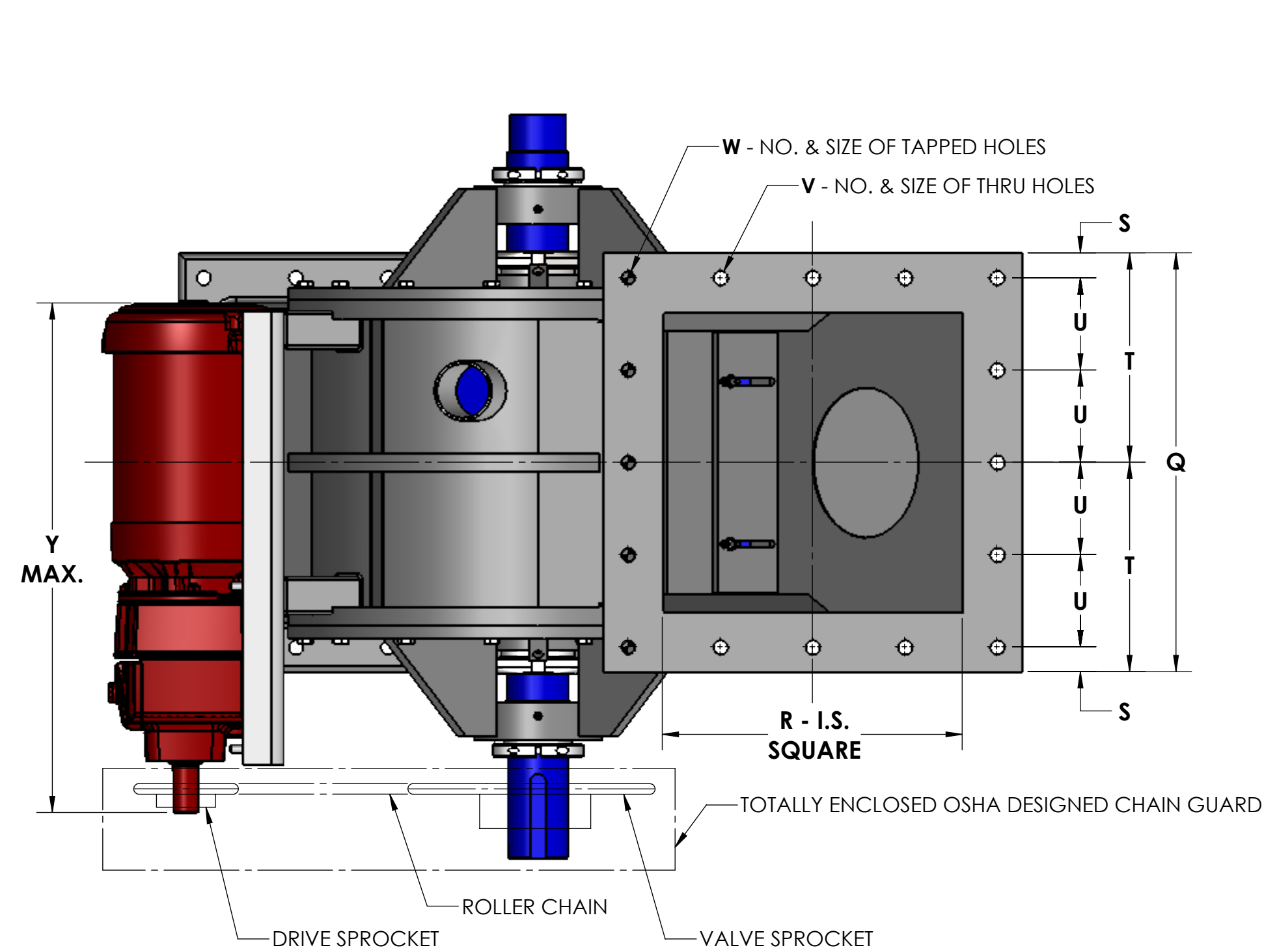

TYPE 'A' ROTOR
 ROTOR SIZES: 4" THRU 12" - 8 VANES
 14" THRU 24" - 12 VANES

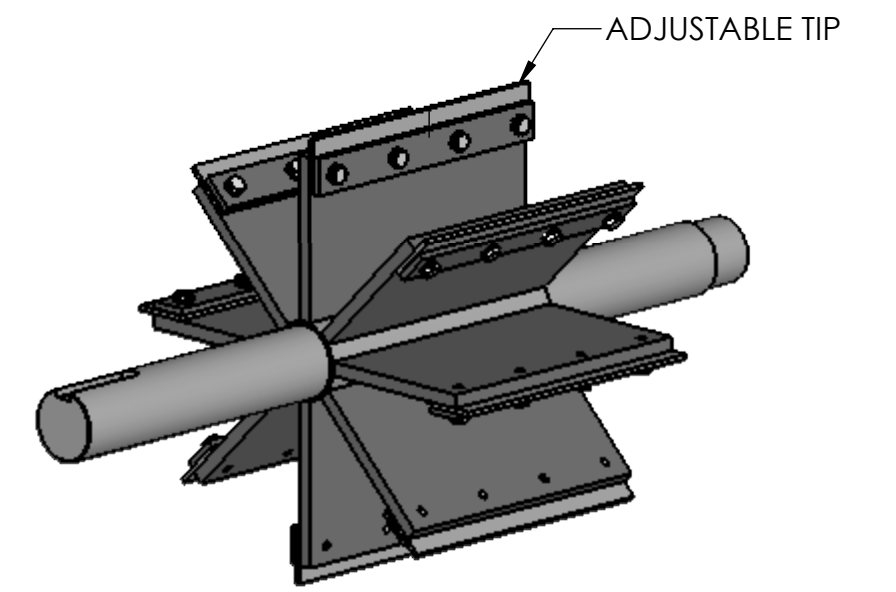
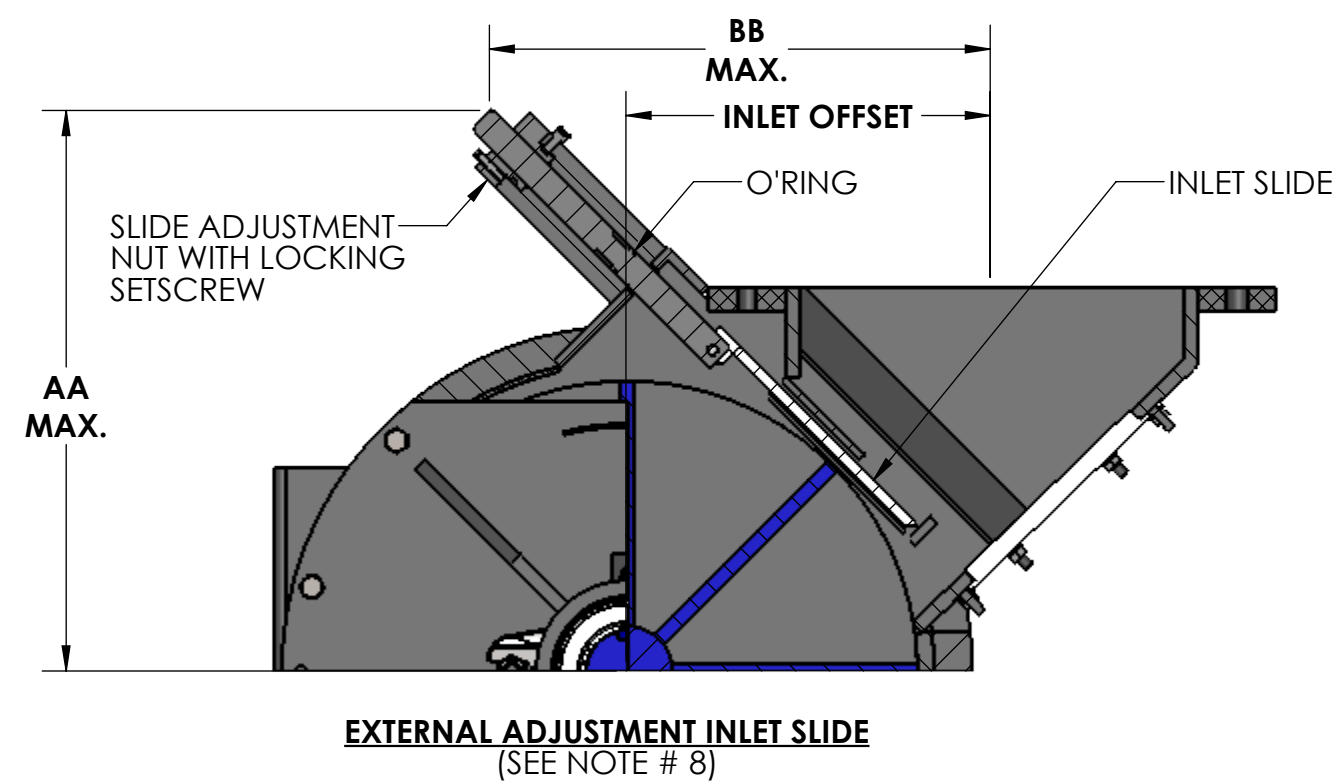

TYPE 'D' ROTOR

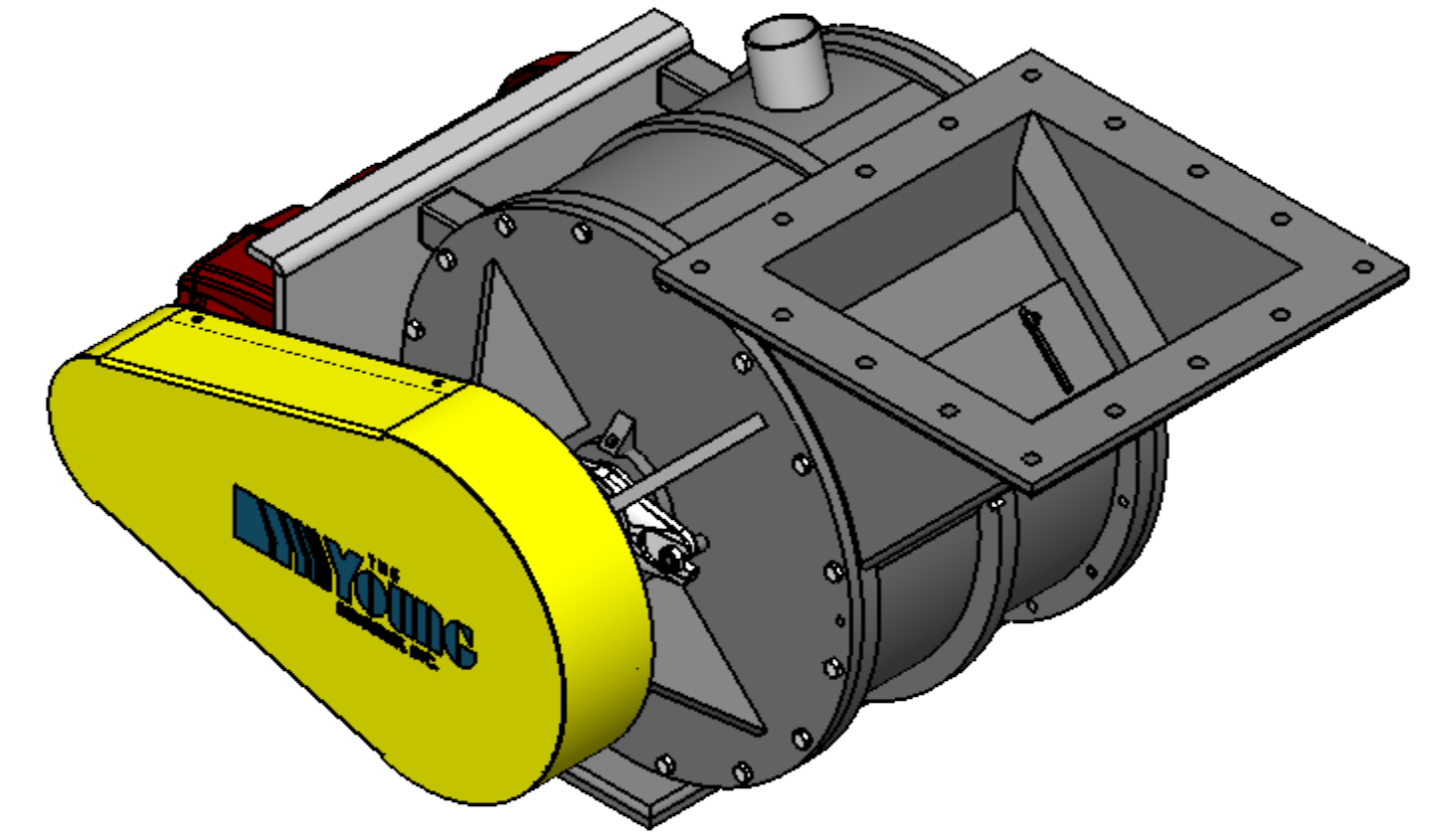
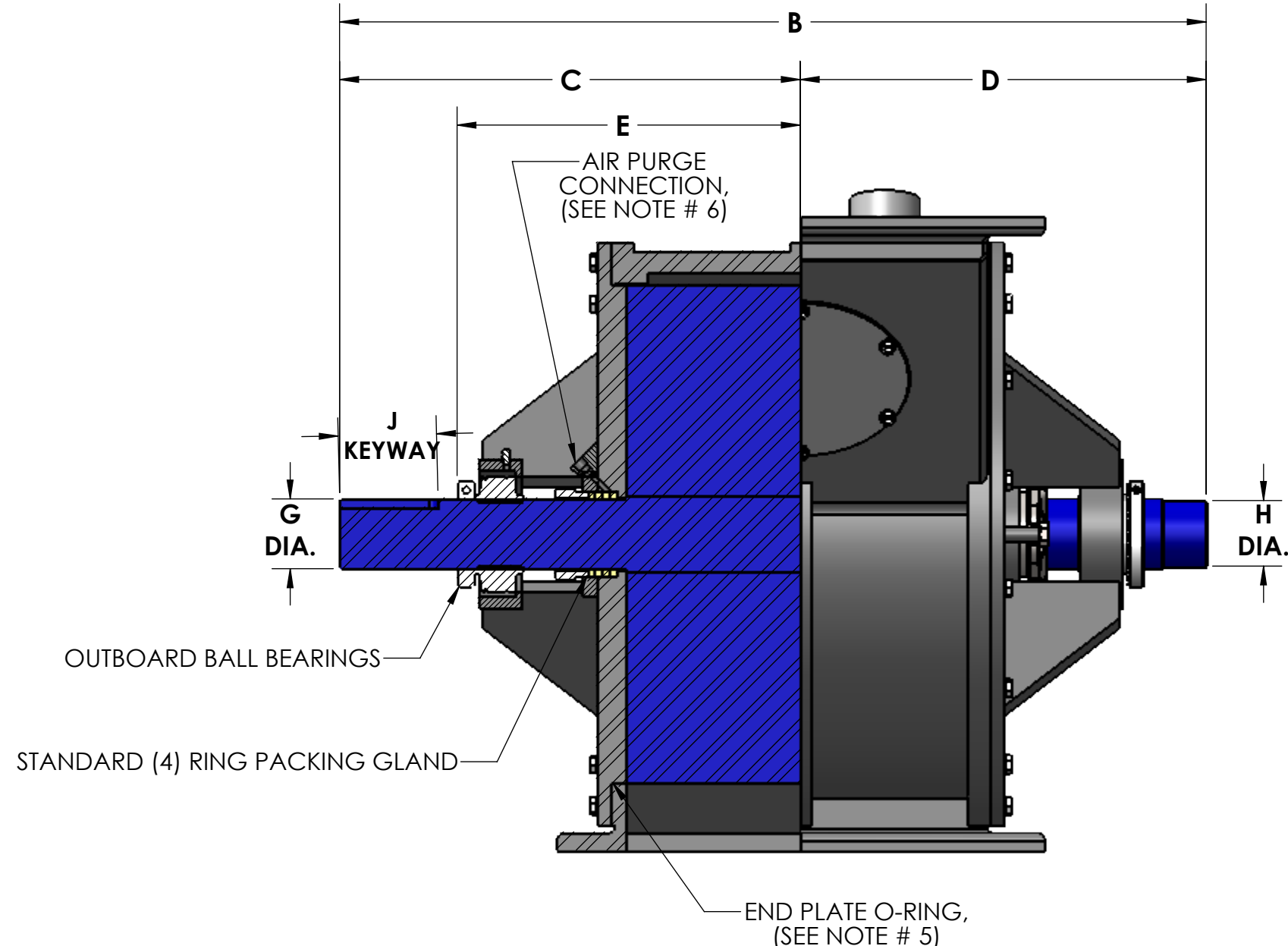
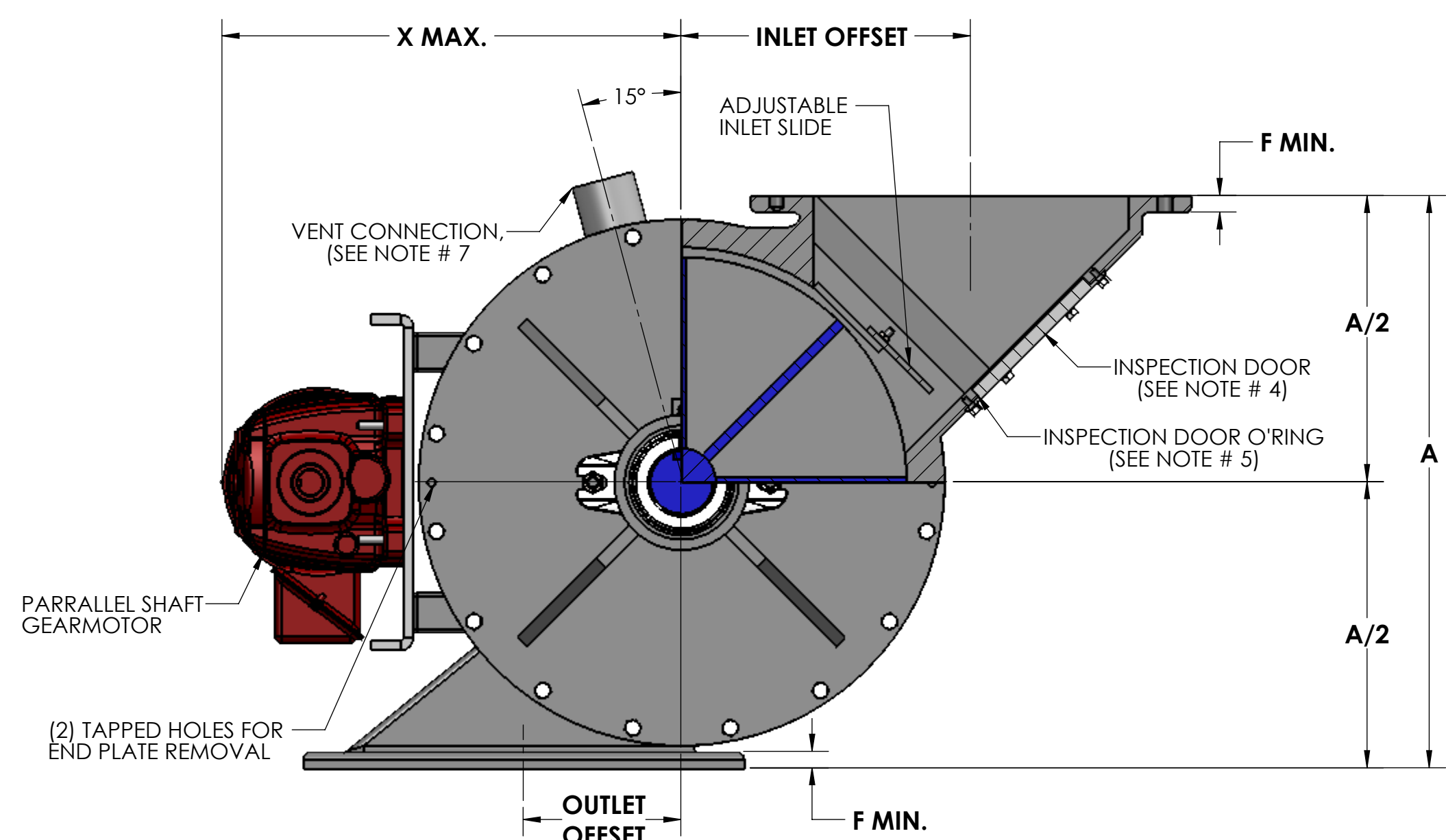

- NOTES:**
1. VALVE HOUSINGS ARE CAST OF IRON OR ALUMINUM; FABRICATED OF STEEL OR STAINLESS STEEL. ALL ROTORS ARE FABRICATED OF STEEL OR STAINLESS STEEL.
 2. VALVE HOUSINGS ARE AVAILABLE WITH A SQUARE OUTLET ONLY. FABRICATED HOUSINGS ARE AVAILABLE WITH EITHER SQUARE OR ROUND INLET ONLY. ROUND FLANGES MATCH 150# ANSI DRILLING. FLANGE DETAIL SHOWS MAXIMUM NO. OF TAPPED HOLES.
 3. STANDARD HOUSINGS ARE DESIGNED FOR 15 PSI (MAX) INTERNAL & DIFFERENTIAL @ 250 DEGREES F.
 4. INSPECTION DOOR IS STANDARD.
 5. END PLATE AND INSPECTION O-RINGS ARE OPTIONAL AND WILL BE FURNISHED ONLY WHEN SPECIFIED.
 6. AIR PURGE CONNECTIONS 1/8" NPT WITH BRASS LANTERN RINGS ARE OPTIONAL AND WILL BE FURNISHED ONLY WHEN SPECIFIED.
 7. VENT WITH SCH 10 PIPE IS OPTIONAL AND WILL BE FURNISHED ONLY WHEN SPECIFIED.
 8. EXTERNAL ADJUSTMENT INLET SLIDE IS OPTIONAL AND WILL BE FURNISHED ONLY WHEN SPECIFIED. EXTERNAL ADJUSTMENT IS AVAILABLE ONLY ON FABRICATED VALVES WITH A SQUARE INLET.

Size	ROTOR DIA x LG.	CAP. CU. FT./REV.		INLET OFFSET	OUTLET OFFSET	STD RPM	VENT SIZE	STD HP	A	B	C	D	E	F	G	H	J	K	L	M	N	P	Q	R	S	T	U	V	W	X	Y	WEIGHT C/S
		A	D																													
4	6 x 4	.0211	.0192	4.00	2.00	38	1.25	.50	10.00	19.25	10.31	7.69	7.31	.31	1.19	1.00	.25 x .12 x 2.62	9.00	7.50	4.00	(6) .56	(2) .50-13UNC-2B	7.50	4.00	.62	3.12	N/A	(6) .56	(2) .50-13UNC-2B	15.06	20.38	205
5	8 x 5	.0492	.0468	5.00	2.50	38	1.50	.50	12.00	20.50	10.94	8.31	7.94	.44	1.44	1.25	.38 x .19 x 2.62	10.00	8.50	5.00	(6) .56	(2) .50-13UNC-2B	8.50	5.00	.62	3.62	N/A	(6) .56	(2) .50-13UNC-2B	14.31	20.38	260
6	10 x 6	.0948	.092	6.00	3.00	32	1.50	.50	14.00	22.38	11.88	9.25	8.88	.44	1.94	1.75	.50 x .25 x 2.62	11.00	9.50	6.00	(6) .56	(2) .50-13UNC-2B	9.50	6.00	.62	4.12	N/A	(6) .56	(2) .50-13UNC-2B	15.38	20.38	310
8	12 x 8	.176	.174	8.00	4.00	32	2.00	.75	17.00	24.38	12.88	10.25	9.88	.44	1.94	1.75	.50 x .25 x 2.62	13.50	11.75	8.00	(12) .56	N/A	11.50	8.00	.62	5.12	2.56	(16) .56	N/A	16.38	20.38	385
10	15 x 10	.357	.354	9.50	5.00	32	2.50	.75	20.00	26.62	13.88	11.25	10.88	.44	2.19	2.00	.50 x .25 x 2.62	16.00	14.25	10.00	(15) .56	(1) .50-13UNC-2B	14.75	10.00	1.00	6.38	3.19	(15) .56	(1) .50-13UNC-2B	18.00	20.38	520
12	17 x 12	.559	.555	11.00	6.00	32	2.50	.75	22.00	29.75	15.81	12.44	12.06	.56	2.44	2.25	.62 x .31 x 3.38	19.00	17.00	12.00	(15) .56	(1) .50-13UNC-2B	16.75	12.00	1.00	7.38	3.69	(15) .56	(1) .50-13UNC-2B	19.00	21.38	660
14	19 x 13	.715	.708	12.00	6.50	32	3.00	.75	24.00	30.75	16.31	12.94	12.56	.56	2.44	2.25	.62 x .31 x 3.38	21.00	18.75	13.00	(15) .56	(1) .50-13UNC-2B	18.00	13.00	1.00	8.00	4.00	(11) .56	(5) .50-13UNC-2B	19.94	21.38	885
16	23 x 15	1.218	1.203	15.00	7.50	30	3.50	1.50	28.00	34.62	18.31	14.81	14.44	.62	2.94	2.75	.75 x .38 x 3.50	23.50	21.25	15.00	(15) .69	(1) .62-11UNC-2B	20.00	15.00	1.00	9.00	4.50	(11) .69	(5) .62-11UNC-2B	23.00	25.75	1,260
18	25 x 17	1.650	1.641	16.00	8.50	28	3.50	1.50	30.00	36.62	19.31	15.81	15.44	.62	2.94	2.75	.75 x .38 x 3.50	25.00	22.75	17.00	(16) .69	N/A	22.00	17.00	1.00	10.00	5.00	(12) .69	(4) .62-11UNC-2B	24.06	25.75	1,510
20	28 x 19	2.369	2.362	18.00	9.50	28	4.00	2.00	36.00	41.38	22.38	17.50	17.12	.75	3.19	3.25	.75 x .38 x 4.50	27.50	25.00	19.00	(16) .75	N/A	25.50	19.00	1.25	11.50	5.75	(12) .81	(4) .75-10UNC-2B	26.62	25.75	2,200
22	32 x 21	3.476	3.469	20.00	10.50	26	5.00	2.00	40.00	45.75	24.81	19.44	19.06	.75	3.69	3.75	.88 x .44 x 5.00	29.75	27.25	21.00	(16) .75	N/A	27.50	21.00	1.25	12.50	6.25	(12) .81	(4) .75-10UNC-2B	28.62	25.75	2,730
24	34 x 23	4.333	4.309	22.00	11.50	24	5.00	2.00	42.00	47.75	25.81	20.44	20.06	.75	3.75	3.75	.88 x .44 x 5.00	32.00	29.50	23.00	(16) .75	N/A	29.50	23.00	1.25	13.50	6.75	(12) .81	(4) .75-10UNC-2B	29.62	25.75	3,000

SPECIFICATIONS ARE SUBJECT TO CHANGE WITHOUT NOTIFICATION

REV. NO.	DESCRIPTION	DATE	BY
REVISIONS			
CUSTOMER			
CUST. NO.			
YOUNG ORDER NO.			
TITLE			
YOUNG INDUSTRIES MODEL 'SE' ROTARY VALVE, SIZE 4" - 24", CLASS 15 WITH PARALLEL SHAFT DRIVE, OPEN ROTOR STANDARD DIMENSION SHEET			
THE YOUNG INDUSTRIES, INC. HUNCY, PENNSYLVANIA 17756 TELEPHONE: 570-546-3165			
DRAWN BY: BMF		DATE DRAWN: 3/21/16	
CHECKED BY:		SCALE: 1:5	
DRAWING NUMBER		REV:	

GENERAL TOLERANCES	
UNLESS OTHERWISE SPECIFIED THE FOLLOWING SHALL APPLY	
MACHINING - .XX= .02 XXX= .005 ANGLE= .50°	
SURFACE ROUGHNESS HEIGHT 63 MICRONS OR LESS	
FABRICATION - UNDER 6" 6 TO 24" 24 TO 60" OVER 60"	
± .06 ± .12 ± .19 ± .25	
UNLESS OTHERWISE SPECIFIED DIMENSIONS ARE IN INCHES	

S-4-6437

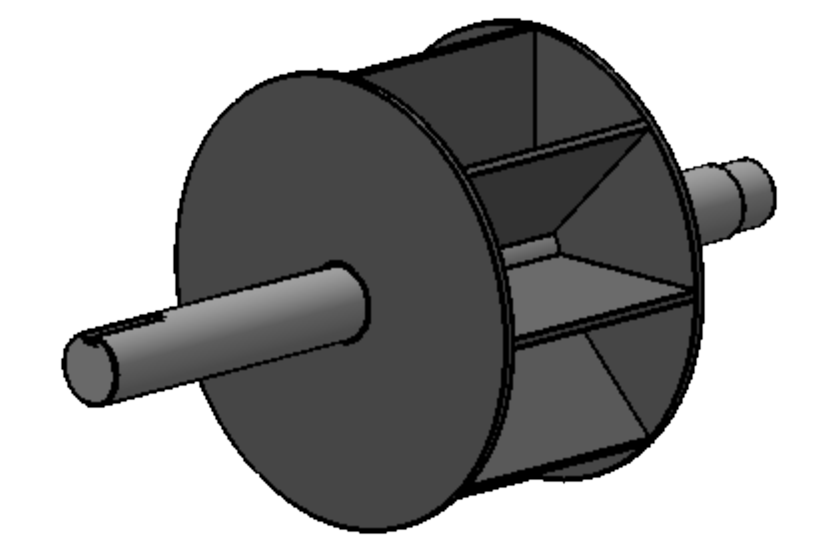
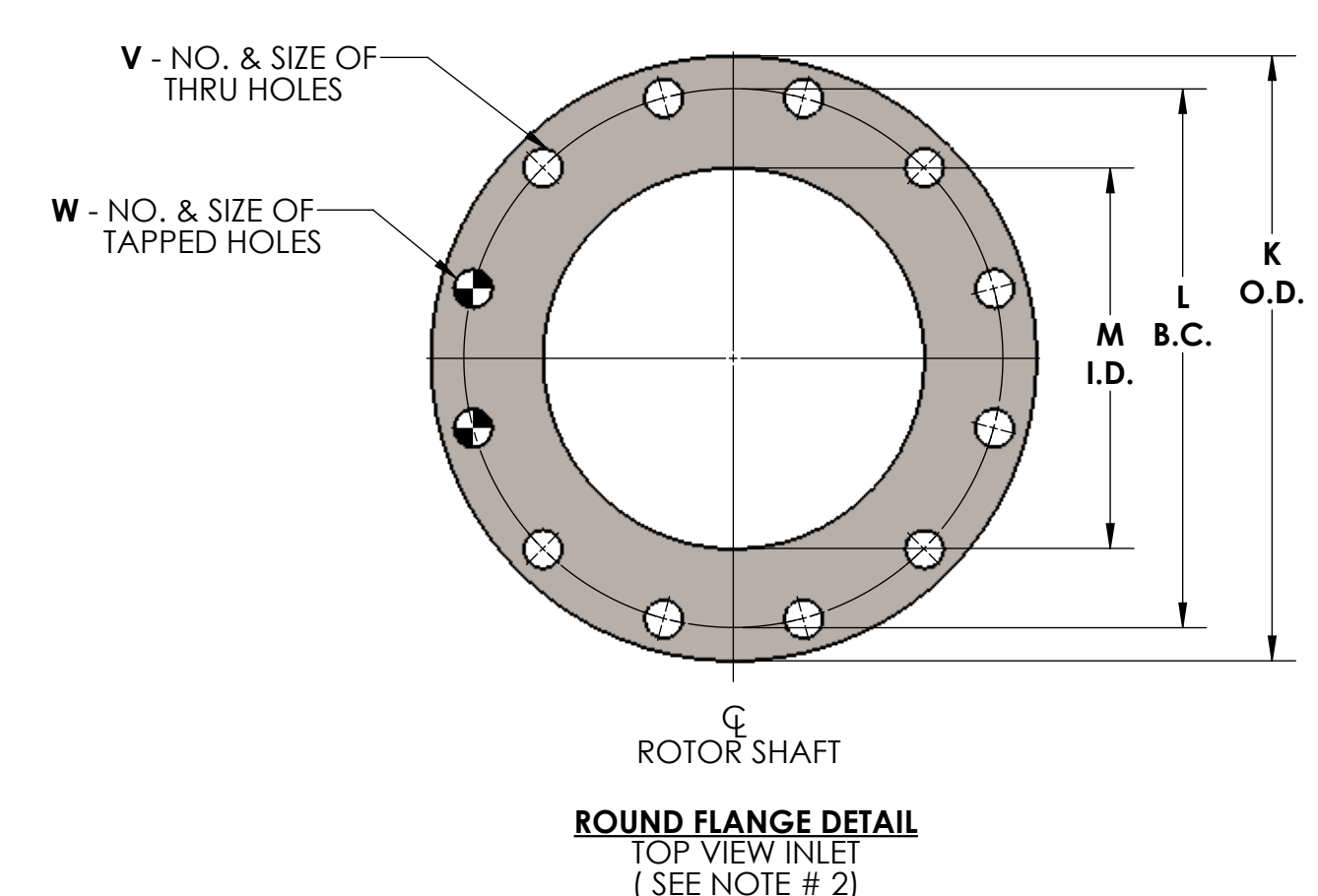
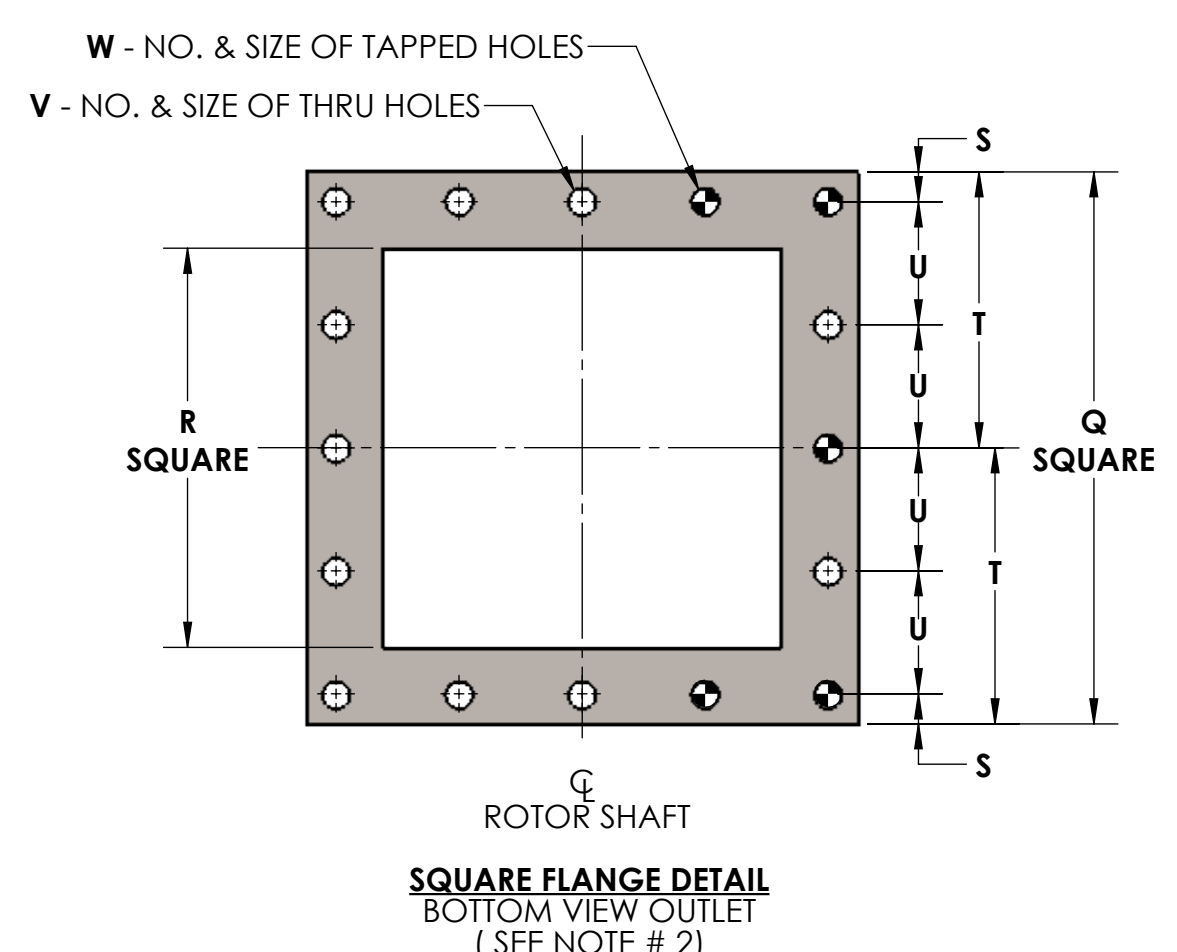
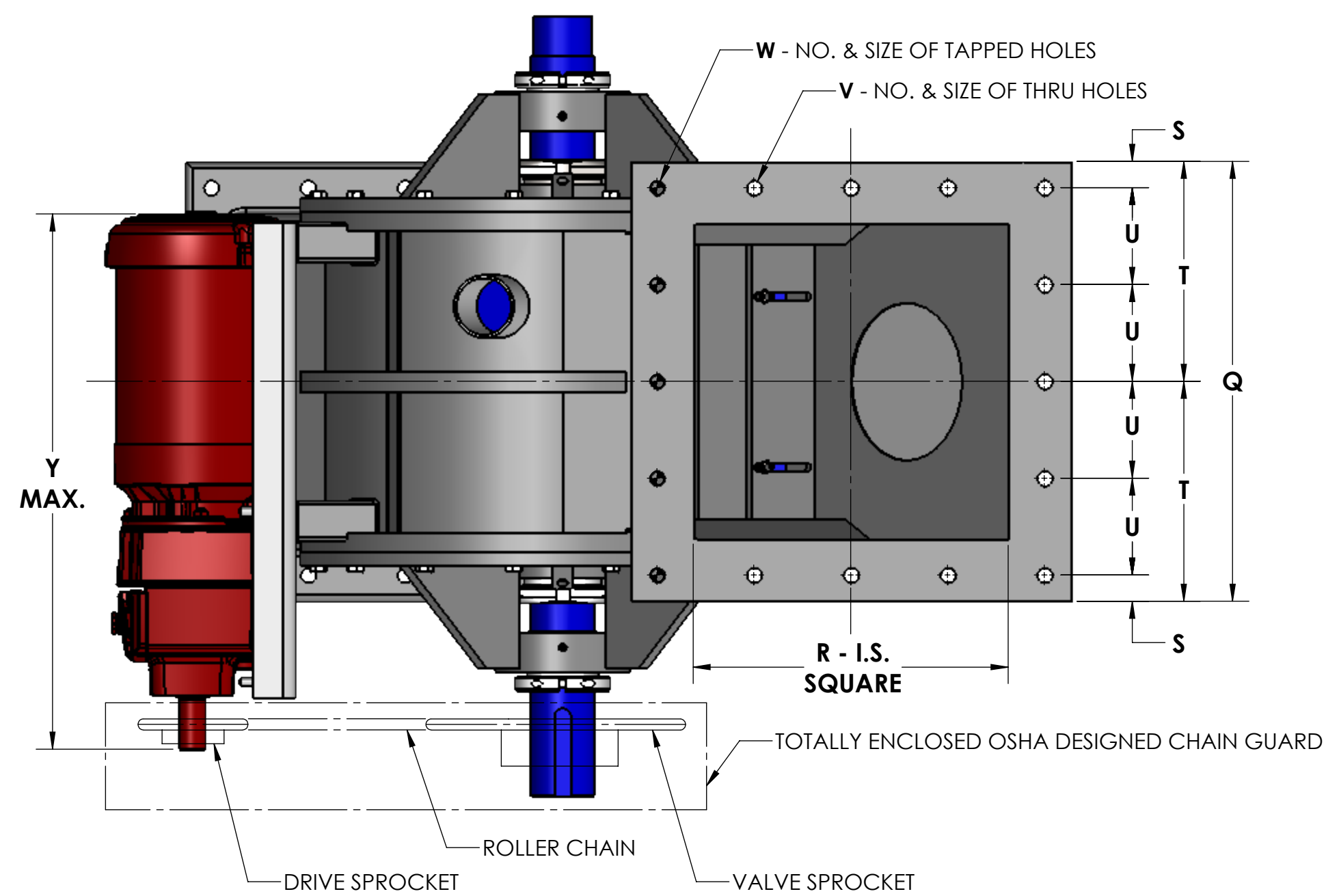

TYPE 'AS' ROTOR

ROTOR SIZES: 4" - 12" - 8 VANES
14" - 24" - 12 VANES

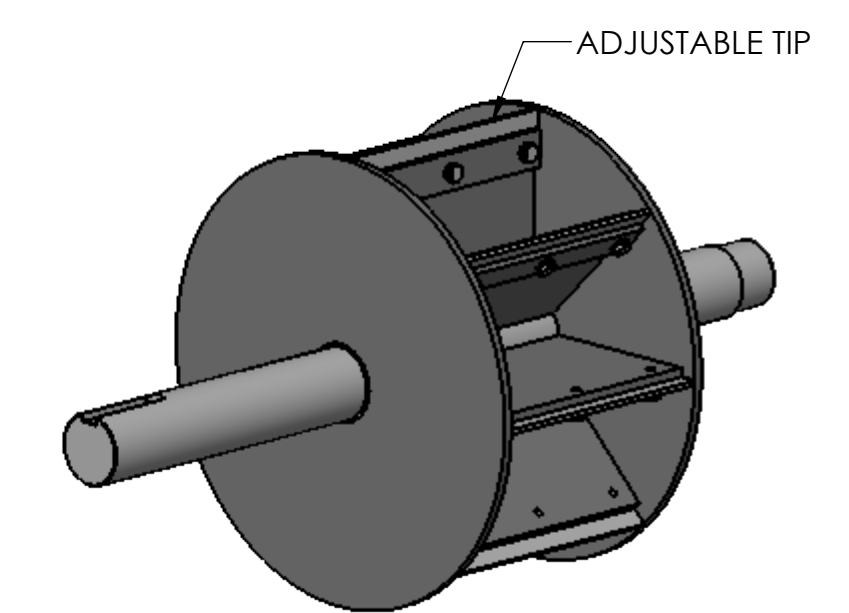

TYPE 'DS' ROTOR

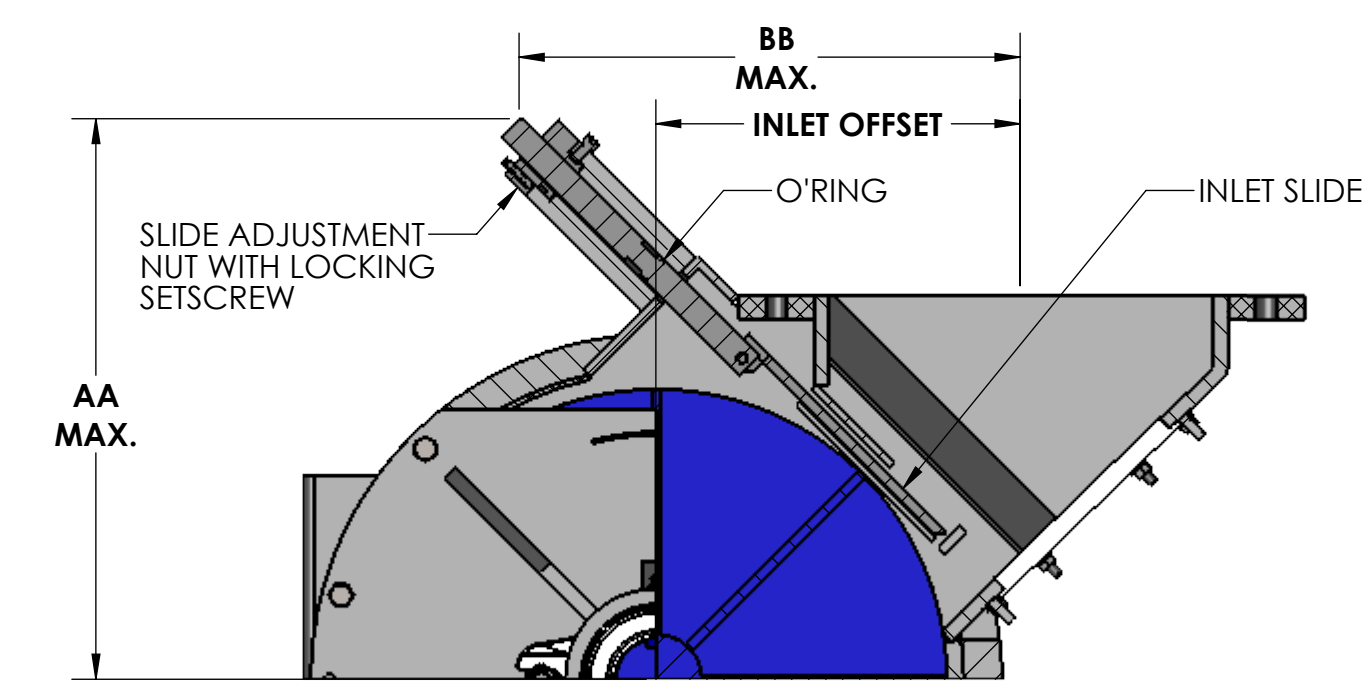

EXTERNAL ADJUSTMENT INLET SLIDE (SEE NOTE # 8)

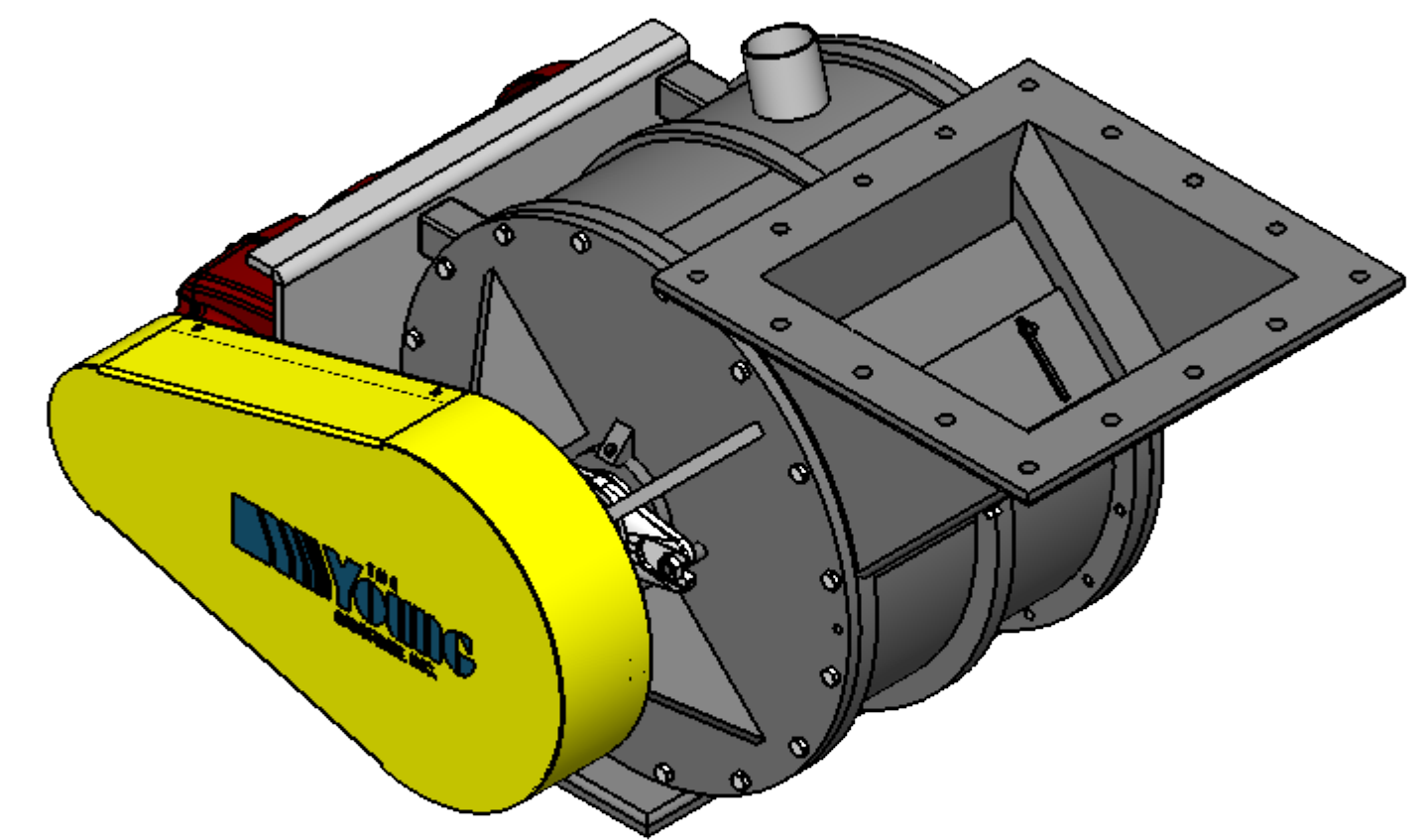
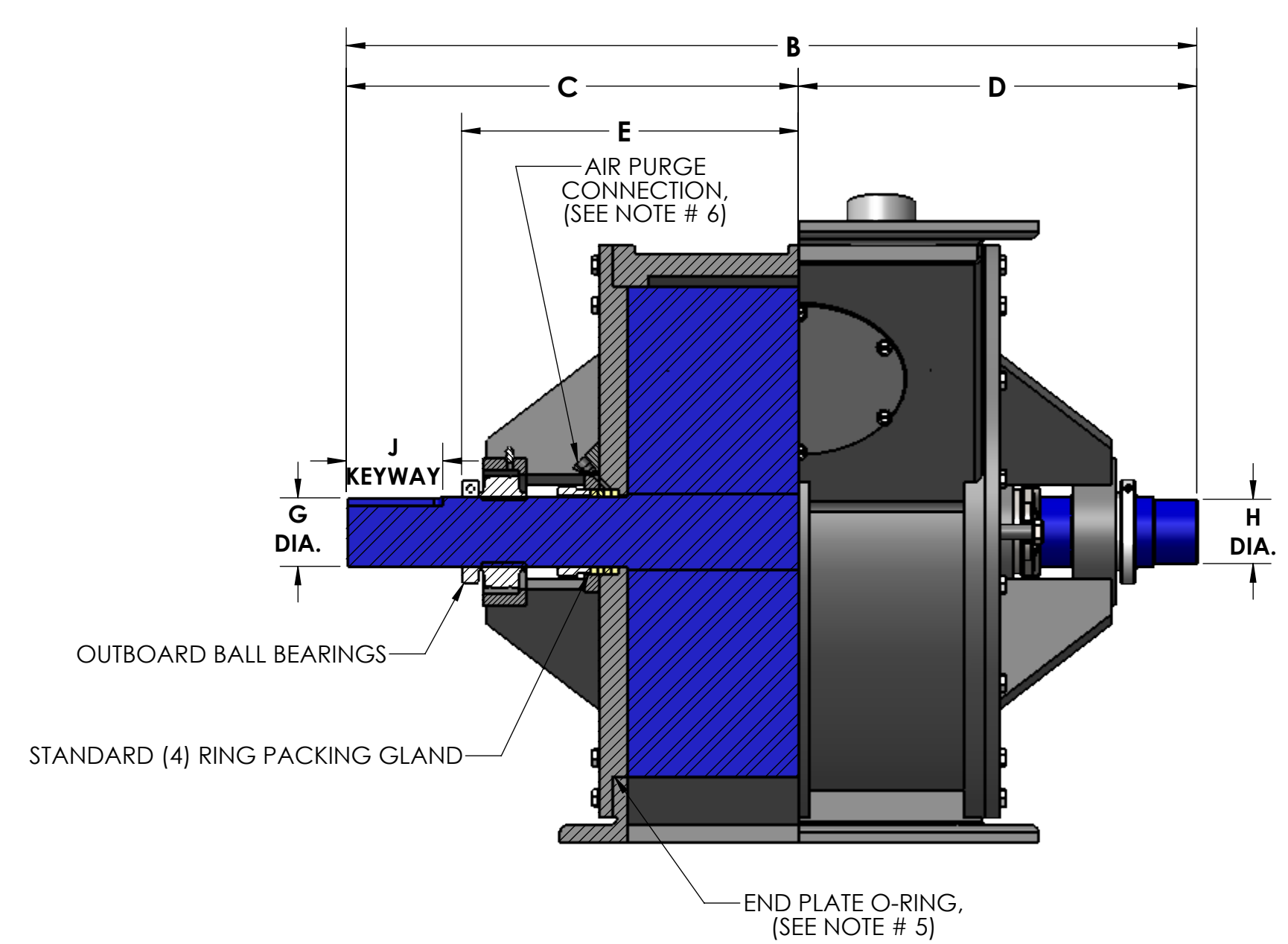
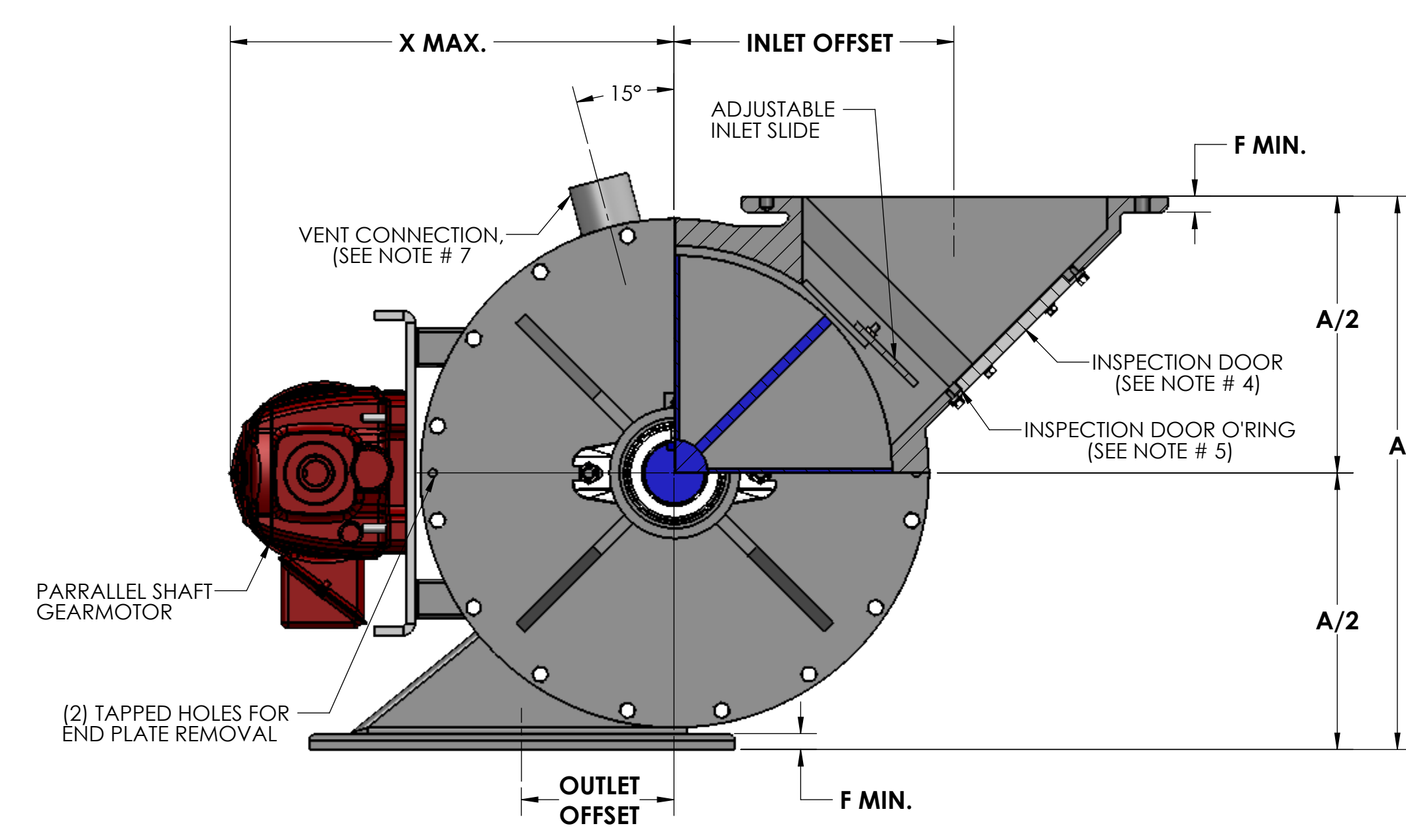

- NOTES:**
1. VALVE HOUSINGS ARE CAST OF IRON OR ALUMINUM; FABRICATED OF STEEL OR STAINLESS STEEL. ALL ROTORS ARE FABRICATED OF STEEL OR STAINLESS STEEL.
 2. VALVE HOUSINGS ARE AVAILABLE WITH A SQUARE OUTLET ONLY. FABRICATED HOUSINGS ARE AVAILABLE WITH EITHER SQUARE OR ROUND INLET ONLY. ROUND FLANGES MATCH 150# ANSI DRILLING. FLANGE DETAIL SHOWS MAXIMUM NO. OF TAPPED HOLES.
 3. STANDARD HOUSINGS ARE DESIGNED FOR 15 PSI (MAX) INTERNAL & DIFFERENTIAL @ 250 DEGREES F.
 4. INSPECTION DOOR IS STANDARD.
 5. END PLATE AND INSPECTION O-RINGS ARE OPTIONAL AND WILL BE FURNISHED ONLY WHEN SPECIFIED.
 6. AIR PURGE CONNECTIONS 1/8" NPT WITH BRASS LANTERN RINGS ARE OPTIONAL AND WILL BE FURNISHED ONLY WHEN SPECIFIED.
 7. VENT WITH SCH 10 PIPE IS OPTIONAL AND WILL BE FURNISHED ONLY WHEN SPECIFIED.
 8. EXTERNAL ADJUSTMENT INLET SLIDE IS OPTIONAL AND WILL BE FURNISHED ONLY WHEN SPECIFIED. EXTERNAL ADJUSTMENT IS AVAILABLE ONLY ON FABRICATED VALVES WITH A SQUARE INLET.

Size	ROTOR DIA x LG.	CAP. CU. FT./REV.	INLET OFFSET	OUTLET OFFSET	STD RPM	VENT SIZE	STD HP	A	B	C	D	E	F	G	H	J	K	L	M	N	P	Q	R	S	T	U	V	W	X	Y	WEIGHT C/S
4	6 x 4	.0171	4.00	2.00	38	1.25	.50	10.00	19.25	10.31	7.69	7.31	.31	1.19	1.00	.25 x .12 x 2.62	9.00	7.50	4.00	(6) .56	(2) .50-13UNC-2B	7.50	4.00	.62	3.12	N/A	(6) .56	(2) .50-13UNC-2B	15.06	20.38	205
5	8 x 5	.0420	5.00	2.50	38	1.50	.50	12.00	20.50	10.94	8.31	7.94	.44	1.44	1.25	.38 x .19 x 2.62	10.00	8.50	5.00	(6) .56	(2) .50-13UNC-2B	8.50	5.00	.62	3.62	N/A	(6) .56	(2) .50-13UNC-2B	14.31	20.38	260
6	10 x 6	.0832	6.00	3.00	32	1.50	.50	14.00	22.38	11.88	9.25	8.88	.44	1.94	1.75	.50 x .25 x 2.62	11.00	9.50	6.00	(6) .56	(2) .50-13UNC-2B	9.50	6.00	.62	4.12	N/A	(6) .56	(2) .50-13UNC-2B	15.38	20.38	310
8	12 x 8	.157	8.00	4.00	32	2.00	.75	17.00	24.38	12.88	10.25	9.88	.44	1.94	1.75	.50 x .25 x 2.62	13.50	11.75	8.00	(12) .56	N/A	11.50	8.00	.62	5.12	2.56	(16) .56	N/A	16.38	20.38	385
10	15 x 10	.326	9.50	5.00	32	2.50	.75	20.00	26.62	13.88	11.25	10.88	.44	2.19	2.00	.50 x .25 x 2.62	16.00	14.25	10.00	(15) .56	(1) .50-13UNC-2B	14.75	10.00	1.00	6.38	3.19	(15) .56	(1) .50-13UNC-2B	18.00	20.38	520
12	17 x 12	.520	11.00	6.00	32	2.50	.75	22.00	29.75	15.81	12.44	12.06	.56	2.44	2.25	.62 x .31 x 3.38	19.00	17.00	12.00	(15) .56	(1) .50-13UNC-2B	16.75	12.00	1.00	7.38	3.69	(15) .56	(1) .50-13UNC-2B	19.00	21.38	660
14	19 x 13	.686	12.00	6.50	32	3.00	.75	24.00	30.75	16.31	12.94	12.56	.56	2.44	2.25	.62 x .31 x 3.38	21.00	17.75	13.00	(15) .56	(1) .50-13UNC-2B	18.00	13.00	1.00	8.00	4.00	(11) .56	(5) .50-13UNC-2B	19.94	21.38	885
16	23 x 15	1.115	15.00	7.50	30	3.50	1.50	28.00	34.62	18.31	14.81	14.44	.62	2.94	2.75	.75 x .38 x 3.50	23.50	21.25	15.00	(15) .69	(1) .62-11UNC-2B	20.00	15.00	1.00	9.00	4.50	(11) .69	(5) .62-11UNC-2B	23.00	25.75	1,260
18	25 x 17	1.528	16.00	8.50	28	3.50	1.50	30.00	36.62	19.31	15.81	15.44	.62	2.94	2.75	.75 x .38 x 3.50	25.00	22.75	17.00	(16) .69	N/A	22.00	17.00	1.00	10.00	5.00	(12) .69	(4) .62-11UNC-2B	24.06	25.75	1,510
20	28 x 19	2.159	18.00	9.50	28	4.00	2.00	36.00	41.38	22.38	17.50	17.12	.75	3.19	3.25	.75 x .38 x 4.50	27.50	25.00	19.00	(16) .75	N/A	25.50	19.00	1.25	11.50	5.75	(12) .81	(4) .75-10UNC-2B	26.62	25.75	2,200
22	32 x 21	3.193	20.00	10.50	26	5.00	2.00	40.00	45.75	24.81	19.44	19.06	.75	3.69	3.75	.88 x .44 x 5.00	29.75	27.25	21.00	(16) .75	N/A	27.50	21.00	1.25	12.50	6.25	(12) .81	(4) .75-10UNC-2B	28.62	25.75	2,730
24	34 x 23	4.015	22.00	11.50	24	5.00	2.00	42.00	47.75	25.81	20.44	20.06	.75	3.75	3.75	.88 x .44 x 5.00	32.00	29.50	23.00	(16) .75	N/A	29.50	23.00	1.25	13.50	6.75	(12) .81	(4) .75-10UNC-2B	29.62	25.75	3,000

SPECIFICATIONS ARE SUBJECT TO CHANGE WITHOUT NOTIFICATION

REV. NO.	DESCRIPTION	DATE	BY
REVISIONS			
CUSTOMER			
CUST. NO.			
YOUNG ORDER NO.			
TITLE			
YOUNG INDUSTRIES MODEL 'SE' ROTARY VALVE, SIZE 4" - 24", CLASS 15 WITH PARRALLEL SHAFT DRIVE, SHROUDED ROTOR STANDARD DIMENSION SHEET			
THE YOUNG INDUSTRIES, INC. MUNCY, PENNSYLVANIA 17756 TELEPHONE: 570-546-3165			
DRAWN BY: BMF		DATE DRAWN: 3/21/16	
CHECKED BY:		SCALE: 1:4	
DRAWING NUMBER		REV:	

GENERAL TOLERANCES	
UNLESS OTHERWISE SPECIFIED THE FOLLOWING SHALL APPLY	
MACHINING - .XX = .02 XXX = .005 ANGLE = .50°	SURFACE ROUGHNESS HEIGHT 63 MICRONS OR LESS
FABRICATION - UNDER 6" 6 TO 24" 24 TO 60" OVER 60"	± .06 ± .12 ± .19 ± .25
UNLESS OTHERWISE SPECIFIED DIMENSIONS ARE IN INCHES	

S-4-7807